

PELL HYDRASHEAR®  
DAPOC2500-94

2-1/2" CAPACITY DOUBLE ACTING  
POWER OPERATED WIRE ROPE CUTTER

OPERATORS MANUAL AND PARTS LIST

PELL HYDRASHEAR division of  
MORSE-STARRETT PRODUCTS CO.

184 NW 10<sup>TH</sup> ST.

MERIDIAN, ID 83642

208-888-7571

[www.morse-starrett.com](http://www.morse-starrett.com)

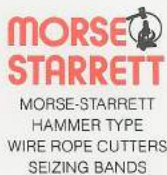

**MORSE-STARRETT PRODUCTS CO.**  
and  
**PELL CABLE CUTTER CO.**



HYDRAULIC CUTTERS  
FOR WIRE ROPE  
PRE-STRESSED STRAND  
REINFORCING BAR  
CHAIN

184 N.W. 10TH STREET  
MERIDIAN, IDAHO 83642

E-mail: sales@morse-starrett.com  
Website: www.morse-starrett.com

(208) 888-7571 • FAX: (208) 888-2092

The DAPOC2500-94 was designed to cut new and unused wire rope. The maximum capacity is 2-1/2". It is not designed to cut solid bar or rebar.

**Due to the work hardening of used cable, the operating life of the blade may be greatly reduced.**

The electric hydraulic pump is designed to operate at a maximum pressure of 10,000 psi. This unit has a 50 ton double acting cylinder that will cut 2-1/2" cable at about 6,000 psi in 40-45 seconds. A double acting cylinder is powered in both directions for a faster and more positive return.

**FOR SAFE OPERATION:**

**WEAR SAFETY GOGGLES WHEN OPERATING THE CUTTER**

**MONITOR PRESSURE GAUGE WHEN IN OPERATION**

**RELEASE CUTTING PRESSURE WHEN CUT HAS COMPLETED AND AFTER CYLINDER IS FULLY RETRACTED. OTHERWISE, PRESSURE WILL CONTINUE TO BUILD RESULTING IN POSSIBLE DAMAGE.**

**IT IS RECOMMENDED THAT THE OPERATOR BECOME FAMILIAR WITH THE DAPOC2500-94 PRIOR TO MAKING HIS FIRST CUT.**



**MORSE-STARRETT PRODUCTS CO.**  
and  
**PELL CABLE CUTTER CO.**

184 N.W. 10TH STREET  
MERIDIAN, IDAHO 83642

E-mail: sales@morse-starrett.com  
Website: www.morse-starrett.com

(208) 888-7571 • FAX: (208) 888-2092

**SAFETY GOGGLES ARE REQUIRED WHEN  
OPERATING THE DAPOC2500-94 CABLE CUTTER**

1. Never leave the cutter unattended when it is in the process of cutting cable.
2. The DAPOC2500-94 cable cutter is supplied with an operator activated hand switch. **(DO NOT OPERATE WITHOUT USING THIS SWITCH)**. This switch is required to keep the operator alert and attending to any problems when the cutter is in use.
3. When cutting the maximum capacity cable, pressure should never exceed 7500 psi.
4. When pressure to cut 2-1/2" cable (maximum capacity) reaches 7000+ psi, the blade should be re-sharpened or replaced.
5. Dies in the shear blade holder (#43DA) should be inspected frequently and replaced as necessary.
6. Never attempt to operate the DAPOC2500-94 without the latch (#33DA) being firmly in place. Operating the cutter without the latch (#33DA) in place will cause damage to the blade (#4) and shear blade holder (#43DA).
7. Turn off the pump when the cutter is not in use.
8. **REPLACING THE BLADE:**
  - a. Remove hinge pin (#6) holding the shear blade holder (#43DA)/latch (#33DA) assembly and remove the assembly.
  - b. Under pressure, extend the ram so the blade pin (#5) hole is exposed. Using a 1/4" diameter rod, drive blade pin (#5) out far enough to release the blade (#4).
  - c. Insert new blade (#4), drive blade pin (#5) through hole, retract the cylinder and replace shear blade holder (#43DA)/latch (#33DA) assembly.

When re-sharpening the blade (#4), use a carbide or fine grinding wheel and re-sharpen to the same angle on blade. Pre-dull sharp edge for longer blade life.

**MORSE-STARRETT PRODUCTS CO.**  
and  
**PELL CABLE CUTTER CO.**

184 N.W. 10TH STREET  
MERIDIAN, IDAHO 83642  
E-mail: sales@morse-starrett.com  
Website: www.morse-starrett.com  
(208) 888-7571 • FAX: (208) 888-2092

**Note: if the blade is too sharp, it will chip. Do not overheat the blade when sharpening.**

**9. REPLACING DIE SET:**

- a. Remove hinge pin (#6) from shear blade holder (#43DA) and place shear blade holder (#43DA) on solid surface.
- b. Remove guard plate (#42) from shear blade holder (#43DA). Through the slot in the back of the shear blade holder (#43DA), drive dies (#1) out with a 1/2" rod and small hammer.
- c. Using a hammer, drive the new dies (#1) into the slots in the shear blade holder (#43DA) by alternately hitting each end of the die (#1) so as to drive the dies (#1) into the shear blade holder (#43DA) evenly. Be sure the longer leg on the die (#1) matches the longer leg on the shear blade holder (#43DA). Re-attach the guard plate (#42).
- d. Be sure that when re-attaching the shear blade holder (#43DA) to the cutter, the longer leg is on the bottom of the cutter.

## **CYLINDER**

### **REMOVING THE CYLINDER:**

When removing the cylinder from the cutting head, unscrew the two 3/8" set screws (#48) from the head.

### **REPLACING THE CYLINDER:**

Thread in cylinder to the maximum stop on head, then back off the screw boss on the cylinder threads then tighten first 3/8" set screw to boss then lock in the second set screw.



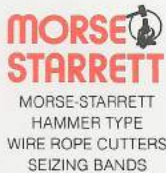

**MORSE-STARRETT PRODUCTS CO.**  
and  
**PELL CABLE CUTTER CO.**



HYDRAULIC CUTTERS  
FOR WIRE ROPE  
PRE-STRESSED STRAND  
REINFORCING BAR  
CHAIN

184 N.W. 10TH STREET  
MERIDIAN, IDAHO 83642

E-mail: [sales@morse-starrett.com](mailto:sales@morse-starrett.com)  
Website: [www.morse-starrett.com](http://www.morse-starrett.com)

(208) 888-7571 • FAX: (208) 888-2092

## **ATTENTION**

WHEN INSTALLING THE BLADE HOLDER (#45), IT IS VERY IMPORTANT TO ALIGN THE BLADE WITH THE CENTER OF THE SHEAR BLADE HOLDER (#43DA).

TO DO THIS, YOU MUST FIRST REMOVE THE SHEAR BLADE HOLDER (#43) AND THE LATCH (#33DA). THEN BOLT THE BLADE HOLDER (#45) ON THE RAM OF THE CYLINDER. AFTER THE BLADE HOLDER (#45) IS INSTALLED, THE BLADE (#4) CAN BE INSERTED AND SECURED WITH THE BLADE PIN (#5). AFTER THE BLADE (#4) IS SECURED WITH THE BLADE PIN (#5), THE RAM CAN BE TWISTED INTO POSITION BY USING A CRESCENT WRENCH ON THE BLADE (#4).

TWIST THE RAM UNTIL THE BLADE IS IN A VERTICAL POSITION THEN REINSTALL THE SHEAR BLADE HOLDER (#43DA) AND THE LATCH (#33DA).

MAKE SURE THAT THE BLADE (#4) IS IN A VERTICAL POSITION AND IN ALIGNMENT WITH THE CUTTING DIES (#1).

**IMPORTANT: DO NOT ATTEMPT TO OPERATE THIS CUTTER UNTIL THE BLADE HAS BEEN PROPERLY ALIGNED.**

**MISALIGNMENT OF THE BLADE CAN CAUSE DAMAGE TO THE CUTTER AND INJURY TO THE OPERATOR.**



MORSE-STARRETT  
HAMMER TYPE  
WIRE ROPE CUTTERS  
SEIZING BANDS

# MORSE-STARRETT PRODUCTS CO. and PELL CABLE CUTTER CO.

184 N.W. 10TH STREET  
MERIDIAN, IDAHO 83642

E-mail: sales@morse-starrett.com  
Website: www.morse-starrett.com

(208) 888-7571 • FAX: (208) 888-2092



HYDRAULIC CUTTERS  
FOR WIRE ROPE  
PRE-STRESSED STRAND  
REINFORCING BAR  
CHAIN

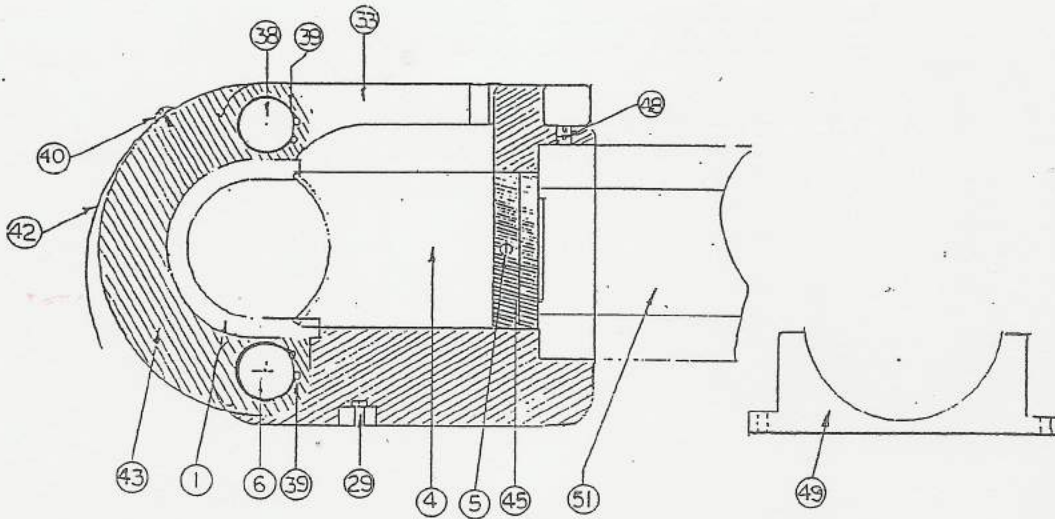

PART NUMBER	DESCRIPTION
M-1	DIE SET
M-4	BLADE
M-5	BLADE PIN
M-6	HINGE PIN
M-29	HOLD DOWN BOLTS (2)
M-33DA	LATCH
M-38 & M-6	LATCH PIN & HINGE PIN
M-39	SNAP RINGS (4)
M-40	GUARD SCREWS (2)
M-42	GUARD PLATE
M-43DA	SHEAR BLADE HOLDER
M-45	BLADE HOLDER
M-48	CYLINDER LOCKING SCREWS (2)
M-49	CYLINDER SUPPORT
M-51	CYLINDER
M-82	HOSE SET
M-83	BASE PLATE
M-84	ELECTRIC PUMP
M-85	PRESSURE GAUGE WITH ADAPTER



To Protect Your Warranty, Use Only ENERPAC Hydraulic Oil.  
Enerpac recommends that all kit components be installed to insure optimum performance of the repaired product.

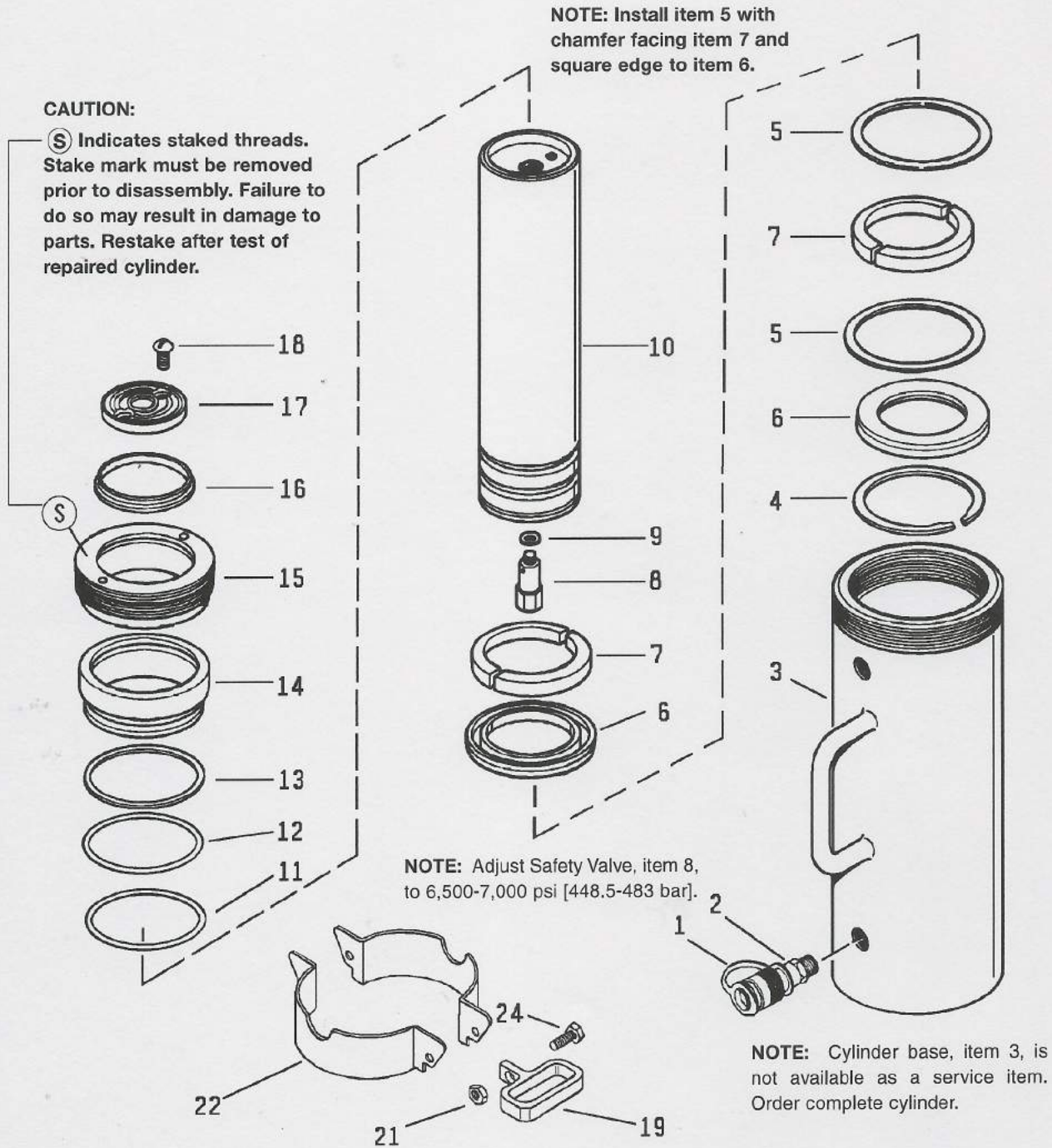

Figure 1, 50-Ton Double-Acting Solid Plunger Hydraulic Cylinder



## Repair Parts List for Figure 1

Item	Part Number		Qty.	Description
	RR-506	RR-5013		
1	CD411	CD411	2	Dust Cap
2	CR400	CR400	2	Coupler
3	Not available as a service item. Order complete cylinder. Cylinder			
4	★	★	1	Retaining Ring
5	★	★	2	Washer
6	★	★	2	U-Cup
7	L341107	L341107	2	Rod Bearing
8	G586900SR-7000	G586900SR-7000	1	Relief Valve Assembly (incl. item 9)
9	★	★	1	Gasket
10	M23040	M24040	1	Plunger
11	★	★	1	O-Ring
12	★	★	1	O-Ring
13	★	★	1	Back-Up Washer
14	M28044	M28044	1	Stop Ring
15	Y193044	Y193044	1	Stop Ring Assembly
16	★	★	1	Wiper Ring
17	L345045	L345045	1	Saddle
18	L661028	L661028	2	Machine Screw
19	---	DA5184070SR	2	Cylinder Handle (incl. item 20,21,23,24)
21	---	DC4453021	2	Hex Nut
22	---	CL1052950SR	2	Collar (incl. item 19,20,21,23,24)
25	CL401271	---	1	Threaded Protector (not shown)

★ Items included in and available only as part of Repair Kit RR5013K1. (For Viton order Kit RR5013KV.)

### Enerpac Worldwide Locations

#### Africa

ENERPAC Middle East FZE  
Office 423, JAFZA 15  
P.O. Box 18004  
Jebel Ali, Dubai  
United Arab Emirates  
Tel: +971 (0)4 8872686  
Fax: +971 (0)4 8872687

#### Australia, New Zealand

Actuant Australia Ltd.  
Block V Unit 3  
Regents Park Estate  
391 Park Road  
Regents Park NSW 2143  
(P.O. Box 261) Australia  
Tel: +61 297 438 988  
Fax: +61 297 438 648

#### Brazil

Power Packer do Brasil Ltda.  
Rua dos Inocentes, 587  
04764-050 - Sao Paulo (SP)  
Tel: +55 11 5687 2211  
Fax: +55 11 5686 5583  
**Toll Free in Brazil:**  
Tel: 0800 891 5770  
vendasbrasil@enerpac.com

#### Canada

Actuant Canada Corporation  
6615 Ordan Drive, Unit 14-15  
Mississauga, Ontario L5T 1X2  
Tel: +1 905 564 5749  
Fax: +1 905 564 0305  
**Toll Free:**  
Tel: +1 800 268 4987  
Fax: +1 800 461 2456  
**Technical Inquiries:**  
techservices@enerpac.com

#### China

Actuant China Ltd.  
1F, 269 Fute N. Road  
Waigaoqiao Free Trade Zone  
Pudong New District  
Shanghai, 200 131 China  
Tel: +86 21 5866 9099  
Fax: +86 21 5866 7156

#### Actuant China Ltd. (Beijing)

709B Diyang Building  
Xin No. 2  
Dong San Huan North Rd.  
Beijing City  
100028 China  
Tel: +86 10 845 36166  
Fax: +86 10 845 36220

#### Central and Eastern Europe, Greece

ENERPAC GmbH  
P.O. Box 300113  
D-40401 Düsseldorf  
Willstätterstrasse 13  
D-40549 Düsseldorf  
Germany  
Tel: +49 211 471 490  
Fax: +49 211 471 49 28

#### France, Switzerland francophone

ENERPAC, Une division de ACTUANT  
France S.A.  
ZA de Courtaboeuf  
32, avenue de la Baltique  
91140 VILLEBON / YVETTE  
France  
Tel: +33 1 60 13 68 68  
Fax: +33 1 69 20 37 50

#### ◆ e-mail: info@enerpac.com

#### Germany, Austria and Switzerland

ENERPAC GmbH  
P.O. Box 300113  
D-40401 Düsseldorf  
Willstätterstrasse 13  
D-40549 Düsseldorf  
Germany  
Tel: +49 211 471 490  
Fax: +49 211 471 49 28

#### India

ENERPAC Hydraulics  
(India) Pvt. Ltd.  
Office No. 9,10 & 11,  
Plot No. 56, Monarch Plaza,  
Sector 11, C.B.D. Belapur  
Navi Mumbai 400614, India  
Tel: +91 22 2756 6090  
Tel: +91 22 2756 6091  
Fax: +91 22 2756 6095

#### Italy

ENERPAC S.p.A.  
Via Canova 4  
20094 Corsico (Milano)  
Tel: +39 02 4861 111  
Fax: +39 02 4860 1288

#### Japan

Applied Power Japan Ltd.  
Besshochou 85-7  
Saitama-shi, Kita-ku,  
Saitama 331-0821  
Japan  
Tel: +81 48 662 4911  
Fax: +81 48 662 4955

#### Middle East, Turkey and Caspian Sea

ENERPAC Middle East FZE  
Office 423, JAFZA 15  
P.O. Box 18004  
Jebel Ali, Dubai  
United Arab Emirates  
Tel: +971 (0)4 8872686  
Fax: +971 (0)4 8872687

#### Russia and CIS (excl. Caspian Sea Countries)

Actuant LLC  
Admiral Makarov Street 8  
125212 Moscow, Russia  
Tel: +7-495-9809091  
Fax: +7-495-9809092

#### Singapore

Actuant Asia Pte. Ltd.  
37C, Benoi Road Pioneer Lot,  
Singapore 627796  
Tel: +65 68 63 0611  
Fax: +65 64 84 5669  
**Toll Free:** +1800 363 7722  
**Technical Inquiries:**  
techsupport@enerpac.com.sg

#### South Korea

Actuant Korea Ltd.  
3Ba 717,  
Shihwa Industrial Complex  
Jungwang-Dong, Shihung-Shi,  
Kyunggi-Do  
Republic of Korea 429-450  
Tel: +82 31 434 4506  
Fax: +82 31 434 4507

#### ◆ Internet: www.enerpac.com

#### Spain and Portugal

ENERPAC  
Avda. Los Frailes, 40 - Nave C & D  
Pol. Ind. Los Frailesancho De Arriba  
(Madrid) Spain  
Tel: +34 91 661 11 25  
Fax: +34 91 661 47 89

#### The Netherlands, Belgium, Luxembourg, Sweden, Denmark, Norway, Finland and Baltic States

ENERPAC B.V.  
Galvanistraat 115, 6716 AE Ede  
P.O. Box 8097, 6710 AB Ede  
The Netherlands  
Tel: +31 318 535 911  
Fax: +31 318 525 613  
+31 318 535 848

#### Technical Inquiries Europe:

techsupport.europe@enerpac.com

#### United Kingdom, Ireland

Enerpac Ltd  
Bentley Road South  
Darlaston, West Midlands  
WS10 8LQ, United Kingdom  
Tel: +44 (0)121 50 50 787  
Fax: +44 (0)121 50 50 799

#### USA, Latin America and Caribbean

ENERPAC  
P.O. Box 3241  
6100 N. Baker Road  
Milwaukee, WI 53209 USA  
Tel: +1 262 781 6600  
Fax: +1 262 783 9562

#### User inquiries:

+1 800 433 2766

#### Inquiries/orders:

+1 800 558 0530

#### Technical Inquiries:

techservices@enerpac.com

**All Enerpac products are guaranteed against defects in workmanship and materials for as long as you own them. For your nearest authorized Enerpac Service Center, visit us at [www.enerpac.com](http://www.enerpac.com)**